



# Catalog of Products

# CONTENTS

PEX Tubing	Radiant Heat PEX Tubing (w/ Oxygen Barrier)	Page 3
	Plumbing PEX Tubing (Non-Barrier)	Page 3
PEX Fittings	Elbows (PEX x PEX)	Page 4
	Tees (PEX x PEX x PEX)	Page 4
	Couplings (PEX x PEX)	Page 4
	Plugs (PEX)	Page 4
	Male Sweat Adapters (PEX x Copper Ftg)	Page 4
	Female Sweat Adapters (PEX x Copper Pipe)	Page 5
	MPT Adapters (PEX x MPT)	Page 5
	FPT Adapters (PEX x FPT)	Page 5
	Male Sweat Elbows (PEX x Copper Ftg)	Page 5
	Male Sweat Elbows (PEX x Copper Pipe)	Page 5
	MPT Elbows (PEX x MPT)	Page 5
	FPT Elbows (PEX x FPT)	Page 6
	Swivel Fixture Adapters (PEX x FPT)	Page 6
	Splicing Kits	Page 6
	Stainless Steel Cinch Clamps	Page 6
	Copper Crimp Rings	Page 6
Tools	PEX Cutters	Page 7
	Crimp Tool Kits	Page 7
	Crimp Tools	Page 8
	Decrimping Tools	Page 8
	Clamp (Cinch) Tools	Page 8
	Clip Guns	Page 8
	Foam Board Staplers	Page 8
Accessories	Snap-in Clips	Page 9
	Plastic Bend Supports	Page 9
	Metal Bend Supports	Page 9
	Tube Talons	Page 9
	Plastic Pipe Clamps	Page 9
	Plastic Support Pipe Clamps	Page 9
	Nylon Zip Ties	Page 9
	Copper Stub Out Elbows	Page 10
	Stud Protector Plates	Page 10
	Escutcheons	Page 10
	Clips (for Clip Guns)	Page 10
	Staples	Page 10
PEX Rails	PEX Rails	Page 11
Heat Transfer Plates	Alumimun Hear Transfer Plates	Page 11
Radiant Manifolds	Stainless Steel Radiant Manifolds & Parts	Page 12
Copper Manifolds	Valveless PEX Headers (PEX x Spin Closed)	Page 12
	Valveless PEX Headers (Open)	Page 12
	PEX Headers w/ Valves (PEX x Spin Closed)	Page 13
	PEX Manifolds w/ Valves (M x F Sweat)	Page 13
	PEX Manifolds w/ Valves (Sweat x Spin Closed)	Page 13
	Valveless Copper Manifolds	Page 13
Heat Exchangers	Brazed Plate Heat Exchangers	Page 14

## PEX TUBING

### RADIANT HEAT PEX TUBING (WITH OXYGEN BARRIER)



PEX Tubing with oxygen barrier is used in heating applications such as radiant heated floors, snow melt systems, baseboard and radiator heating systems and boiler / wood furnace supply and return lines.

External oxygen barrier coating protects ferrous components from corrosion and assures a longer life and better performance of the system.

Everhot Oxygen Barrier PEX is a PEX-B type tubing.

- ASTM F876/F877
- DIN4726
- NSF/ANSI 14, nsf-rfh
- CSA B137.5
- UPC/IAPMO

Part#	Product Description	Color	Packing
BPR3810	3/8" x 1000 ft PEX tubing with oxygen barrier	red	1/box
BPR3850	3/8" x 500 ft PEX tubing with oxygen barrier	red	1/box
BPR3830	3/8" x 300 ft PEX tubing with oxygen barrier	red	1/box
BPR1210	1/2" x 1000 ft PEX tubing with oxygen barrier	red	1/box
BPR1250	1/2" x 500 ft PEX tubing with oxygen barrier	red	1/box
BPR1230	1/2" x 300 ft PEX tubing with oxygen barrier	red	1/box
BPR5850	5/8" x 500 ft PEX tubing with oxygen barrier	red	1/box
BPR5830	5/8" x 300 ft PEX tubing with oxygen barrier	red	1/box
BPR3450	3/4" x 500 ft PEX tubing with oxygen barrier	red	1/box
BPR3430	3/4" x 300 ft PEX tubing with oxygen barrier	red	1/box
BPR1030	1" x 300 ft PEX tubing with oxygen barrier	red	1/box
BPR1001	1" x 100 ft PEX tubing with oxygen barrier	red	3/bundle

### PLUMBING PEX TUBING (NON-BARRIER)



Non-Barrier PEX Tubing is commonly used for domestic hot and cold water plumbing applications.

A variety of colors allows installer to designate different color PEX pipes for selected water temperatures and types.

Everhot Non-Barrier PEX is a PEX-B type tubing.

- ASTM F876/F877/2023
- NSF/ANSI 14
- NSF/ANSI 61, nsf-pw
- NSF P171
- CSA B137.5
- UPC/IAPMO

Part#	Product Description	Color	Packing
NPR3830	3/8" x 300 ft non-barrier PEX tubing	red	1/box
NPR1210	1/2" x 1000 ft non-barrier PEX tubing	red	1/box
NPR1250	1/2" x 500 ft non-barrier PEX tubing	red	1/box
NPR1230	1/2" x 300 ft non-barrier PEX tubing	red	1/box
NPR1201	1/2" x 100 ft non-barrier PEX tubing	red	5/bundle
NPR3450	3/4" x 500 ft non-barrier PEX tubing	red	1/box
NPR3430	3/4" x 300 ft non-barrier PEX tubing	red	1/box
NPR3401	3/4" x 100 ft non-barrier PEX tubing	red	5/bundle
NPR1030	1" x 300 ft non-barrier PEX tubing	red	1/box
NPR1001	1" x 100 ft non-barrier PEX tubing	red	3/bundle
NPB3830	3/8" x 300 ft non-barrier PEX tubing	blue	1/box
NPB1210	1/2" x 1000 ft non-barrier PEX tubing	blue	1/box
NPB1250	1/2" x 500 ft non-barrier PEX tubing	blue	1/box
NPB1230	1/2" x 300 ft non-barrier PEX tubing	blue	1/box
NPB1201	1/2" x 100 ft non-barrier PEX tubing	blue	5/bundle
NPB3450	3/4" x 500 ft non-barrier PEX tubing	blue	1/box
NPB3430	3/4" x 300 ft non-barrier PEX tubing	blue	1/box
NPB3401	3/4" x 100 ft non-barrier PEX tubing	blue	5/bundle
NPB1030	1" x 300 ft non-barrier PEX tubing	blue	1/box
NPB1001	1" x 100 ft non-barrier PEX tubing	blue	3/bundle
NPW1250	1/2" x 500 ft non-barrier PEX tubing	white	1/box
NPW1230	1/2" x 300 ft non-barrier PEX tubing	white	1/box
NPW3430	3/4" x 300 ft non-barrier PEX tubing	white	1/box

## BRASS PEX FITTINGS

- ASTM F1807, Crimp Style Fittings. NSF 61, UPC.

### ELBOWS (PEX x PEX 90°)



Part#	Product Description	Bag Qty	Box Qty
BPF6801	3/8" Equal Elbow	50	500
BPF6802	1/2" Equal Elbow	50	500
BPF6803	1/2" x 3/4" Reducing Elbow	50	300
BPF6804	5/8" Equal Elbow	10	100
BPF6805	3/4" Equal Elbow	50	300
BPF6806	1" Equal Elbow	25	150

### TEES (PEX x PEX x PEX)



Part#	Product Description	Bag Qty	Box Qty
BPF6912	3/8" Equal Tee	50	300
BPF6901	1/2" Equal Tee	50	300
BPF6902	1/2" x 1/2" x 3/4" Reducing Tee	50	300
BPF6903	3/4" x 1/2" x 1/2" Reducing Tee	50	300
BPF6904	3/4" x 1/2" x 3/4" Reducing Tee	50	300
BPF6905	3/4" x 3/4" x 1/2" Reducing Tee	50	300
BPF6906	3/4" Equal Tee	50	300
BPF6910	3/4" x 3/4" x 1" Reducing Tee	10	150
BPF6907	1" x 3/4" x 3/4" Reducing Tee	25	150
BPF6911	1" x 1" x 1/2" Reducing Tee	10	150
BPF6908	1" x 1" x 3/4" Reducing Tee	25	150
BPF6909	1" Equal Tee	25	150

### COUPLINGS (PEX x PEX)



Part#	Product Description	Bag Qty	Box Qty
BPF7001	3/8" Equal Coupling	50	500
BPF7002	3/8" x 1/2" Reducing Coupling	50	500
BPF7003	1/2" Equal Coupling	50	500
BPF7004	1/2" x 5/8" Reducing Coupling	25	500
BPF7005	1/2" x 3/4" Reducing Coupling	50	500
BPF7006	5/8" Equal Coupling	20	200
BPF7007	5/8" x 3/4" Reducing Coupling	20	200
BPF7008	3/4" Equal Coupling	50	500
BPF7010	3/4" x 1" Reducing Coupling	25	250
BPF7009	1" Equal Coupling	50	200

### PLUGS (PEX)



Part#	Product Description	Bag Qty	Box Qty
BPF7102	1/2" Plug	100	1000
BPF7103	5/8" Plug	20	200
BPF7104	3/4" Plug	100	500
BPF7105	1" Plug	50	500

### MALE SWEAT ADAPTERS (PEX x COPPER FITTING ADAPTER)



Part#	Product Description	Bag Qty	Box Qty
BPF7201	1/2" PEX x 1/2" Male Sweat Adapter	50	500
BPF7202	1/2" PEX x 3/4" Male Sweat Adapter	50	300
BPF7203	5/8" PEX x 3/4" Male Sweat Adapter	10	100
BPF7204	3/4" PEX x 3/4" Male Sweat Adapter	50	300
BPF7205	1" PEX x 3/4" Male Sweat Adapter	25	200
BPF7206	1" PEX x 1" Male Sweat Adapter	25	200

## BRASS PEX FITTINGS

- ASTM F1807, Crimp Style Fittings. NSF 61, UPC.

### FEMALE SWEAT ADAPTERS (PEX x COPPER PIPE ADAPTER)



Part#	Product Description	Bag Qty	Box Qty
BPF7301	1/2" PEX x 1/2" Female Sweat Adapter	50	500
BPF7302	1/2" PEX x 3/4" Female Sweat Adapter	50	300
BPF7303	5/8" PEX x 3/4" Female Sweat Adapter	10	100
BPF7304	3/4" PEX x 3/4" Female Sweat Adapter	50	300
BPF7305	1" PEX x 1" Female Sweat Adapter	25	150

### MALE THREAD ADAPTER (PEX x MPT)



Part#	Product Description	Bag Qty	Box Qty
BPF7401	3/8" PEX x 1/2" MPT Adapter	10	100
BPF7402	1/2" PEX x 1/2" MPT Adapter	50	300
BPF7403	1/2" PEX x 3/4" MPT Adapter	50	250
BPF7404	5/8" PEX x 1/2" MPT Adapter	10	100
BPF7405	5/8" PEX x 3/4" MPT Adapter	10	100
BPF7408	3/4" PEX x 1/2" MPT Adapter	50	200
BPF7406	3/4" PEX x 3/4" MPT Adapter	50	300
BPF7408	3/4" PEX x 1" MPT Adapter	25	150
BPF7409	1" PEX x 3/4" MPT Adapter	25	150
BPF7407	1" PEX x 1" MPT Adapter	25	150

### FEMALE THREAD ADAPTER (PEX x FPT)



Part#	Product Description	Bag Qty	Box Qty
BPF7501	3/8" PEX x 1/2" FPT Adapter	10	100
BPF7502	1/2" PEX x 1/2" FPT Adapter	50	300
BPF7503	1/2" PEX x 3/4" FPT Adapter	50	250
BPF7504	5/8" PEX x 1/2" FPT Adapter	10	100
BPF7505	5/8" PEX x 3/4" FPT Adapter	10	100
BPF7508	3/4" PEX x 1/2" FPT Adapter	50	300
BPF7506	3/4" PEX x 3/4" FPT Adapter	25	250
BPF7507	1" PEX x 1" FPT Adapter	10	100

### MALE SWEAT ELBOWS (PEX x COPPER FITTING 90° ADAPTER)



Part#	Product Description	Bag Qty	Box Qty
BPF7601	1/2" PEX x 1/2" Male Sweat Elbow	50	500
BPF7602	1/2" PEX x 3/4" Male Sweat Elbow	25	100
BPF7603	3/4" PEX x 3/4" Male Sweat Elbow	25	100

### FEMALE SWEAT ELBOWS (PEX x COPPER PIPE 90° ADAPTER)



Part#	Product Description	Bag Qty	Box Qty
BPF7701	1/2" PEX x 1/2" Female Sweat Elbow	50	250
BPF7702	1/2" PEX x 3/4" Female Sweat Elbow	25	100
BPF7703	3/4" PEX x 3/4" Female Sweat Elbow	25	100

### MALE THREAD ELBOWS (PEX x MPT 90°)



Part#	Product Description	Bag Qty	Box Qty
BPF7801	1/2" PEX x 1/2" MPT Elbow	50	250
BPF7802	1/2" PEX x 3/4" MPT elbow	25	100
BPF7803	3/4" PEX x 3/4" MPT elbow	25	100
BPF7804	3/4" PEX x 1" MPT elbow	25	100

## BRASS PEX FITTINGS

- ASTM F1807, Crimp Style Fittings. NSF 61, UPC.

### FEMALE THREAD ELBOWS (PEX x FPT 90°)



Part#	Product Description	Bag Qty	Box Qty
BPF7901	1/2" PEX x 1/2" FPT Elbow	10	100
BPF7902	3/4" PEX x 1/2" FPT Elbow	10	100
BPF7903	3/4" PEX x 3/4" FPT Elbow	10	100

### DROP EAR ELBOWS (PEX x FPT 90°)



Part#	Product Description	Bag Qty	Box Qty
BPF8001	1/2" PEX x 1/2" FPT Drop Ear Elbow	25	100
BPF8002	1/2" PEX x 3/4" FPT Drop Ear Elbow	25	100
BPF8004	3/4" PEX x 1/2" FPT Drop Ear Elbow	25	100
BPF8003	3/4" PEX x 3/4" FPT Drop Ear Elbow	25	100

### SWIVEL FIXTURE ADAPTERS (PEX INSERT, PLASTIC NUT)



Part#	Product Description	Bag Qty	Box Qty
BPF8101	1/2" PEX x 1/2" FPT Swivel Adapter	1	100

### SPLICING KITS



Part#	Product Description	Bag Qty	Box Qty
BPF8201	1/2" PEX Splicing Kit	1	100
BPF8202	3/4" PEX Splicing Kit	1	100

- Features a single PEX x PEX coupling and (2) appropriate size crimp rings (F1807)

### STAINLESS STEEL CINCH CLAMPS (F2098)



Part#	Product Description	Bag Qty	Box Qty
BPF8402	1/2" Stainless Steel Clamps	100	2,000
BPF8403	3/4" Stainless Steel Clamps	100	1,000
BPF8405	1" Stainless Steel Clamps	50	500

### COPPER CRIMP RINGS (F1807)



Part#	Product Description	Bag Qty	Box Qty
BPF8501	3/8" Copper Crimp Ring	100	1,000
BPF8502	1/2" Copper Crimp Ring	100	1,000
BPF8503	5/8" Copper Crimp Ring	50	500
BPF8504	3/4" Copper Crimp Ring	50	500
BPF8505	1" Copper Crimp Ring	50	250
BPF8506	1 1/4" Copper Crimp Ring	25	120



## TOOLS

### PEX TUBING CUTTER MODEL #2



Part#	Product Description	Box Qty	Case Qty
PXT3012	PEX Cutter #2	1	50

- Compact, light weight & easy to use.
- For tubing sizes up to 1".

### PEX TUBING CUTTER MODEL #4



Part#	Product Description	Box Qty	Case Qty
PXT3014	PEX Cutter #4	1	24

- Professional grade tool.
- Ergonomic & labor saving design.
- For tubing sizes up to 1 1/4".

### PEX TUBING CUTTER MODEL #5



Part#	Product Description	Box Qty	Case Qty
PXT3015	PEX Cutter #5	1	24

- Heavy duty tool.
- Ergonomic & labor saving design.
- Blade adjusting mechanism allows to work with 1 specific tubing size.
- For PEX tubing sizes up to 1 1/2".

### PEX CRIMP TOOL KIT



Part#	Product Description	Box Qty	Case Qty
PXT3201	Tool Kit for 5 Sizes(3/8"-1")	1	6

PXT3201 Crimp Tool Kit features a crimp tool with interchangeable jaws for PEX tubing sizes 3/8", 1/2", 5/8", 3/4" and 1". This kit also includes a go-no-go gauge tool for all of the above sizes and a manual, which provides instructions on tool calibration, jaw changing and checking crimp connections for accuracy. Also included: crescent wrench for calibration and jaw changing purposes. All in a durable carrying case.

### PEX CRIMP TOOL KIT WITH DECRIMPING TOOL



Part#	Product Description	Box Qty	Case Qty
PXT3202	Tool Kit for 4 Sizes(3/8"-3/4")	1	6

PXT3202 Crimp Tool Kit features a crimp tool with interchangeable jaws for PEX tubing sizes 3/8", 1/2", 5/8", 3/4" and a PXT3101 decrimping tool. This kit also includes a go-no-go gauge tool for all of the above sizes and a manual, which provides instructions on tool calibration, jaw changing and checking crimp connections for accuracy. Also included: crescent wrench for calibration and jaw changing purposes. All in a durable carrying case.

### PEX CRIMP TOOL KIT FOR 1" & 1-1/4" PEX.



Part#	Product Description	Box Qty	Case Qty
PXT3203	Tool Kit for 2 Sizes(1" & 1-1/4")	1	6

PXT3203 Crimp Tool Kit features a crimp tool with interchangeable jaws for PEX tubing sizes 1" and 1-1/4". This kit also includes a go-no-go gauge tool for all of the above sizes and a manual, which provides instructions on tool calibration, jaw changing and checking crimp connections for accuracy. Also included: crescent wrench for calibration and jaw changing purposes. All in a durable carrying case.

## TOOLS

### DECRIMPING TOOL (FOR COPPER CRIMP RINGS)



Part#	Product Description	Box Qty	Case Qty
PXT3101	Decrimping Tool	1	10

- Professional grade tool.
- Features adjusting knob for various crimp ring sizes.

### PEX CRIMP TOOL



Part#	Product Description	Box Qty	Case Qty
PXT3112	Crimp Tool for 1/2" PEX	1	20
PXT3134	Crimp Tool for 3/4" PEX	1	20

- Jaws are removable and can be replaced with other sizes up to 1".
- Set includes single size go-no-go gage & crescent wrench.
- Calibration instructions are on the tool.

### CLAMP (CINCH) TOOL FOR STAINLESS STEEL CLAMPS



Part#	Product Description	Box Qty	Case Qty
PXT3010	Clamp Tool	1	20

- One tool works with SS Clamps sizes 3/8", 1/2", 5/8", 3/4" & 1".

### MANUAL PEX CLIP GUN



Part#	Product Description	Box Qty	Case Qty
RB-5	Manual PEX Clip Gun	1	20

Clip gun is perfect for underfloor installations when PEX tubing has to be stapled to underneath the subfloor. Can also be used for support of appropriate size copper pipes.

- Holds up to 20 clips.
- Shoot 3 times per clip.
- Compact, light weight & easy to use.
- For tubing sizes up to 3/4". Use with P4BK and P6BK clips.

### PNEUMATIC PEX CLIP GUN



Part#	Product Description	Box Qty	Case Qty
RB-6	Pneumatic PEX Clip Gun	1	6

Pneumatic clip gun is a great tool for radiant heating contractors who install PEX tubing regularly. Easily connected to a compressor. Hose not included.

- Holds up to 20 clips.
- Shoot once per clip.
- Compact & durable.
- For tubing sizes up to 3/4". Use with P4BK and P6BK clips.

### FOAM BOARD PEX STAPLER



Part#	Product Description	Box Qty	Case Qty
RSST	PEX Foam Board Stapler	1	2

Foam board stapler allows to secure PEX tubing to foam board insulation with PEX staples.

- Holds up to 200 staples.
- Compatible with staples from different manufacturers.
- Light weight & durable design.
- Press once per staple.
- For tubing sizes up to 3/4". Use with S5RE-16 staples.



## INSTALLATION ACCESSORIES

### SNAP-IN CLIPS



Part#	Product Description	Bag Qty	Case Qty
PXA4021	1/2" Plastic Snap-in Clips	130	1,300
PXA4041	1/2" Plastic Snap-in Clips	80	800
PXA4051	1/2" Plastic Snap-in Clips	40	400

- Compatible with PEX, CPVC and copper pipes.

### PLASTIC PEX BEND SUPPORTS



Part#	Product Description	Bag Qty	Case Qty
PXA4211	Plastic Bend Support for 1/2" PEX	50	400
PXA4221	Plastic Bend Support for 3/4" PEX	20	200

- Complete with drop ear for easy fastening.
- Fiber reinforced.

### METAL PEX BEND SUPPORTS



Part#	Product Description	Bag Qty	Case Qty
PXA4311	Metal Bend Support for 1/2" PEX	50	300
PXA4321	Metal Bend Support for 1/2" PEX	20	160

- Galvanized Steel.
- For use in concrete slabs.

### TUBE TALONS (J-CLAMP W/ NAIL)



Part#	Product Description	Bag Qty	Case Qty
PXA4411	1/2" Tube Talon with Nail	100	1,000
PXA4421	3/4" Tube Talon with Nail	100	1,000
PXA4431	1" Tube Talon with Nail	50	500

- Compatible with PEX, CPVC and copper pipes.

### TWIN TALONS (W/ NAIL)



Part#	Product Description	Bag Qty	Case Qty
555-23	Twin Talon with Nail	100	1,000

- Compatible with PEX, CPVC and copper pipes.
- One size fits 1/2", 5/8" and 3/4" pipes.

### PLASTIC PIPE CLAMPS



Part#	Product Description	Bag Qty	Case Qty
PXA4611	1/2" Plastic Pipe Clamp	100	1,000
PXA4621	3/4" Plastic Pipe Clamp	100	1,000
PXA4631	1" Plastic Pipe Clamp	50	500

- Compatible with PEX, CPVC and copper pipes.

### PLASTIC SUSPENSION PIPE CLAMPS



Part#	Product Description	Bag Qty	Case Qty
PXA4711	1/2" Plastic Suspension Pipe Clamp	100	1,000
PXA4721	3/4" Plastic Suspension Pipe Clamp	100	1,000
PXA4731	1" Plastic Suspension Pipe Clamp	50	500

- Compatible with PEX, CPVC and copper pipes.

### NYLON CABLE TIES (ZIP TIES)



Part#	Product Description	Bag Qty	Case Qty
PXA4811	8" Cable Tie	500	10,000
PXA4821	14" Cable Tie	200	4,000

- Material: Nylon 66 (UL recognized).

## INSTALLATION ACCESSORIES

### COPPER STUB OUT ELBOWS



Part#	Product Description	Box Qty	Case Qty
630X246	3-1/2" x 6" PEX Stub Out Elbow	50	-
<ul style="list-style-type: none"><li>• F1807</li><li>• 1/2" CTS copper</li></ul>			

### COPPER STUB OUT ELBOWS W/ SQUARE O-STRAP



Part#	Product Description	Box Qty	Case Qty
630X248E	3-1/2" x 8" PEX Stub Out Elbow	50	-
<ul style="list-style-type: none"><li>• F1807</li><li>• 1/2" CTS copper</li><li>• Features a copper strap pre-drilled with 8 holes.</li></ul>			

### STEEL STUD GUARDS



Part#	Product Description	Box Qty	Case Qty
530-3	1-1/2" long x 3" wide Stud Guard	100	-
<ul style="list-style-type: none"><li>• 18 gauge steel</li><li>• Self-nailing</li></ul>			

### STEEL SHALLOW ESCUTCHEONS



Part#	Product Description	Box Qty	Case Qty
920-2	1/2" CTS Shallow Escutcheon	25	250
<ul style="list-style-type: none"><li>• Fits 1/2" copper pipe size.</li><li>• Chrome plated steel.</li></ul>			

### PLASTIC SHALLOW ESCUTCHEONS



Part#	Product Description	Bag Qty	Case Qty
920-2W	1/2" CTS Shallow Escutcheon	25	250
<ul style="list-style-type: none"><li>• Fits 1/2" copper pipe size.</li><li>• Corrosion-proof.</li><li>• Cost-effective.</li></ul>			

### PEX CLIPS FOR RB-5 and RB-6 CLIP GUNS

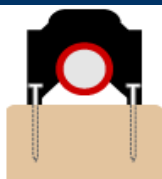

Part#	Product Description	Box Qty	Case Qty
P4BK	1/2" Stand-off Clip	100	10,000
P6BK	3/4" Stand-off Clip	100	10,000
<ul style="list-style-type: none"><li>• For use with RB-5 and RB-6 clip guns.</li><li>• 10 clips per magazine.</li></ul>			

### PEX STAPLES FOR RSST FOAM BOARD STAPLER

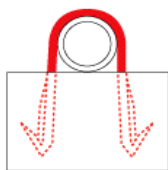

Part#	Product Description	Box Qty	Case Qty
S5RE-16	PEX Staples for 2" thick foam board.	200	10,000
<ul style="list-style-type: none"><li>• For use with RSST foam board stapler tool.</li><li>• Fits over PEX tubing sizes up to 3/4" (7/8" OD).</li><li>• 50 staples per magazine.</li></ul>			

### MANUAL PEX STAPLES



Part#	Product Description	Bag Qty	Case Qty
PXA4911	PEX Staples for 1" thick foam board.	200	4,000
<ul style="list-style-type: none"><li>• No tool required.</li><li>• Fits over PEX tubing sizes up to 1/2" (5/8" OD).</li><li>• Bulk in a bag</li></ul>			

## PEX RAILS

### 1/2" PEX RAILS



Part#	Product Description	Bndl Qty	Palet Qty
PXR12-16	1/2" PEX Rail	16	1600

- Each rail is 6.5ft long.
- Tubing channels at every 2".
- Rails are break-away at every 4".
- Pre-drilled with holes for concrete nails and foam board clips.
- 104ft total per bundle.
- (1) Bundle covers area of ~300 sq. ft at 3ft rail spacing.

### PEX RAILS (3/8", 1/2", 5/8", 3/4")



Part#	Product Description	Box Qty	Palet Qty
PXRALL-100	1/2" PEX Rail	100	1600

- Each rail is 3.3ft long.
- Fits 3/8", 1/2", 5/8" and 3/4" PEX Tubing.
- Tubing channels at every 4".
- Tubing spacing is 4", 8", 12" and 16".
- Can easily be connected to form any desired rail length.
- Flexible and durable, manufactured from nylon.
- Pre-drilled with holes for concrete nails and foam board clips.
- 330ft total per box.
- (1) Box covers area of ~950 sq. ft at 3ft rail spacing.

## ALUMINUM HEAT TRANSFER PLATES

### STAMPED HEAT TRANSFER PLATES



Part#	Product Description	Box Qty	Pallet Qty
HPT12-2-100	1/2" PEX Heat Transfer Plates	100	2400

- 2ft long each.
- 200ft total per box.
- 0.019 thick.
- 5" wide.
- Omega-shaped tubing channel.
- Stamped aluminum.

### EXTRUDED HEAT TRANSFER PLATES



Part#	Product Description	Box Qty	Case Qty
HPT12-4-20	1/2" PEX Heat Transfer Plates	20	500

- 4ft long each.
- 80ft total per box.
- 0.055 thick.
- 3.5" wide.
- Reversed Omega-shaped tubing channel.
- Extruded aluminum.

## STAINLESS STEEL RADIANT MANIFOLDS

### RADIANT MANIFOLD PACKAGES

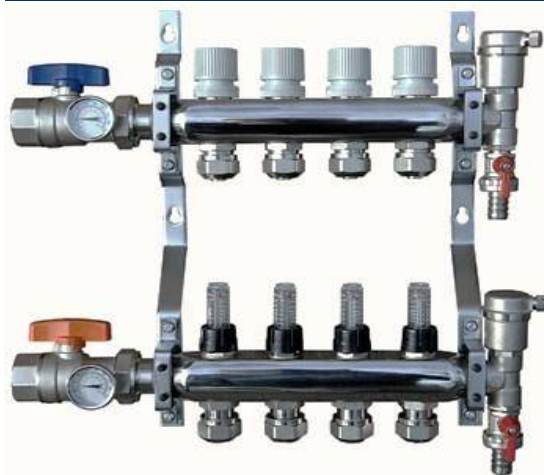

Part#	Product Description	Box Qty
SSM002	2-branch St. Steel Manifold Set	1
SSM003	3-branch St. Steel Manifold Set	1
SSM004	4-branch St. Steel Manifold Set	1
SSM005	5-branch St. Steel Manifold Set	1
SSM006	6-branch St. Steel Manifold Set	1
SSM007	7-branch St. Steel Manifold Set	1
SSM008	8-branch St. Steel Manifold Set	1
SSM009	9-branch St. Steel Manifold Set	1
SSM010	10-branch St. Steel Manifold Set	1
SSM101	Manifold Actuator, 24V, 2-wire	1
SSM538	Manifold Adapter, compr., 3/8" PEX	-
SSM512	Manifold Adapter, compr., 1/2" PEX	-
SSM558	Manifold Adapter, compr., 5/8" PEX	-
SSM534	Manifold Adapter, crimp., 3/4" PEX	-
SSM212	Manifold Adapter, compr., 1/2" PAP	-

Everhot Radiant Manifolds are packed with features:

- Stainless Steel Body - durable, corrosion-proof, professionally looking.
- Manual Balancing Valves - allow to adjust fluid flow to reach desired temperature balance in the system.
- Flow Indicators - allow to monitor and adjust liquid flow through selected circuits.
- Air Vents - will help to eliminate unwanted air from the system.
- Universal Manifold Outlets - accommodate all sizes of PEX and PEX-AL-PEX adapters.
- Drain Valves - allow to conveniently drain and fill the system (hose connection).
- 1" Shut-off Ball Valves - allow to isolate manifold for pressure testing or maintenance purposes.
- Mounting Brackets - designed to offset the manifold from the wall and allow for a more convenient access.
- Manifold Actuators - automatic balancing valves allow to zone the manifold as required.

## COPPER MANIFOLDS

### VALVELESS PEX HEADERS (PEX x SPIN CLOSED)



Part#	Product Description	Bulk / box
672X0390	3-port Copper Manifold, less valves	10
672X0490	4-port Copper Manifold, less valves	10
672X0690	6-port Copper Manifold, less valves	10
672X0890	8-port Copper Manifold, less valves	10
672X1090	10-port Copper Manifold, less valves	10

- 1/2" PEX branches (F1807)
- 3/4" PEX Inlet (F1807)
- Outlet spin closed.
- Branches are 2" OC.

### VALVELESS PEX HEADERS (OPEN)



Part#	Product Description	Bulk / box
672X0399	3-port Copper Manifold, less valves	10
672X0499	4-port Copper Manifold, less valves	10
672X0699	6-port Copper Manifold, less valves	10
672X0899	8-port Copper Manifold, less valves	10
672X1099	10-port Copper Manifold, less valves	10

- 1/2" PEX branches (F1807)
- 3/4" PEX inlet (F1807)
- 3/4" PEX outlet (F1807)
- Both ends open.
- Branches are 2" OC.

## PEX PLUMBING MANIFOLDS & HEADERS

### PEX HEADERS WITH VALVES (PEX x SPIN CLOSED)



Part#	Product Description	Box Qty
672XV0490	4-port Copper Manifold, with valves	1
672XV0590	5-port Copper Manifold, with valves	1
672XV0690	6-port Copper Manifold, with valves	1

- 1/2" PEX, 1/4-turn valve branches (F1807).
- 3/4" PEX inlet (F1807) on left side.
- 1" copper pipe size trunk.
- Spin closed.
- Branches are 2" OC.

### PEX MANIFOLDS WITH VALVES (F x M SWEAT)



Part#	Product Description	Box Qty
672XV0242	2-port Copper Manifold, with valves	1
672XV0342	3-port Copper Manifold, with valves	1
672XV0442	4-port Copper Manifold, with valves	1

- 1/2" PEX, 1/4-turn valve branches (F1807).
- 1" copper fitting size inlet (left side).
- 1" copper pipe size outlet (right side).
- 1" copper pipe size trunk.
- Both ends open.
- Can be soldered together to create a desired # of ports.
- Branches are 2" OC.

### PEX MANIFOLDS WITH VALVES (SWEAT x SPIN CLOSED)



Standard type



Left hand type

Part#	Product Description	Box Qty
672XV0810	8-port Copper Manifold, w/ valves	1
672XV0810L	8-port Copper Manifold, w/ valves - Left	1
672XV1010	10-port Copper Manifold, w/ valves	1
672XV1010L	10-port Copper Manifold, w/ valves - Left	1
672XV1210	12-port Copper Manifold, w/ valves	1
672XV1210L	12-port Copper Manifold, w/ valves - Left	1

- 1/2" PEX, 1/4-turn valve branches (F1807).
- 1" copper fitting size inlet.
- Outlet spin closed.
- 1" copper pipe size trunk.
- Available in standard and Left hand types.
- Branches are 2" OC.

### VALVELESS COPPER MANIFOLDS



Part#	Product Description	Box Qty
6795L-12333	12-port Copper Manifold, 1-1/4" trunk	1
6796L-12333	12-port Copper Manifold, 1-1/2" trunk	1

- 3/4" copper pipe size outlets.
- Both ends open.
- Spin closed.
- 1" copper pipe size trunk.
- Available in standard and Left hand types.
- Branches are 3" OC.



## BRAZED PLATE HEAT EXCHANGERS

### STAINLESS STEEL HEAT EXCHANGERS (COPPER BRAZED)

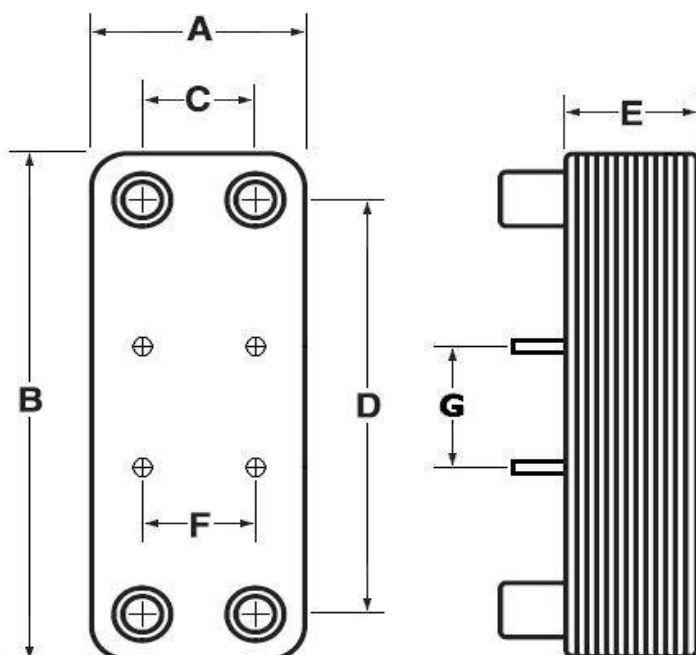

#### Technical Specifications:

- Cover plates, channel plates and outlets are 316L Stainless Steel.
- Braze material - Copper.
- Available with and without mounting studs.
- Max. design temperature is 437F.
- Max. working pressure is 435 psi.

#### Applications:

- Radiant Heating Systems.
  - Snow Melt Systems.
  - Domestic Water.
  - Swimming Pools\*.
  - Glycol Solutions.
  - Shell and tube heat exchanger replacements.
- \*Chlorinated water may be corrosive to 316L st. steel and copper. Proper chlorine control is required.

- Same size connections on both sides.



#### Installation Requirements:

- Heat exchanger must be piped in counterflow directions.
- Fluid must be maintained at 6.5-8.5 pH.
- Strainers with 20 or greater mesh must be installed on both heat exchanger's inlets to avoid fouling.

Part#	No. of plates	Max GPM	Ports MNPT	Studs	A (in.)	B (in.)	C (in.)	D (in.)	E (in.)	F (in.)	G (in.)
HX3x8-30	30	15	3/4"	-	2.99"	8.11"	1.65"	6.77"	3.11"	-	-
HX5x12-10	10	30	1"	-	4.25"	12.12"	1.97"	9.84"	1.32"	-	-
HX5x12-20	20	40	1"	-	4.25"	12.12"	1.97"	9.84"	2.24"	-	-
HX5x12-30	30	40	1"	-	4.25"	12.12"	1.97"	9.84"	3.17"	-	-
HX5x12-40	40	40	1"	-	4.25"	12.12"	1.97"	9.84"	4.09"	-	-
HX5x12-50	50	40	1"	-	4.25"	12.12"	1.97"	9.84"	5.02"	-	-
HX5x12-60	60	40	1"	-	4.25"	12.12"	1.97"	9.84"	5.94"	-	-
HX5x12-70	70	40	1"	-	4.25"	12.12"	1.97"	9.84"	6.87"	-	-
HX5x12-30S	30	40	1"	yes	4.25"	12.12"	1.97"	9.84"	3.17"	2.50"	3.50"
HX5x12-40S	40	40	1"	yes	4.25"	12.12"	1.97"	9.84"	4.09"	2.50"	3.50"
HX5x12-50S	50	40	1"	yes	4.25"	12.12"	1.97"	9.84"	5.02"	2.50"	3.50"
HX5x12-60S	60	40	1"	yes	4.25"	12.12"	1.97"	9.84"	5.94"	2.50"	3.50"
HX5x12-70S	70	40	1"	yes	4.25"	12.12"	1.97"	9.84"	6.87"	2.50"	3.50"
HX5x12C-50S	50	60	1-1/4"	yes	5.00"	11.96"	2.60"	9.85"	5.08	2.50"	3.50"
HX5x12C-60S	60	60	1-1/4"	yes	5.00"	11.96"	2.76"	9.84"	6.02	2.50"	3.50"
HX5x12C-70S	70	60	1-1/4"	yes	5.00"	11.96"	2.76"	9.84"	6.97	2.50"	3.50"

Dimensional data is subject to manufacturing tolerances.